

SW 100#07 Mrs. Seven

Raised Saloon Version



LENGTH OVERALL	Meters	30.20	Feet	99.08
LENGTH OF WATERLINE	M	26.26	Ft	86.15
BEAM	M	6.70	Ft	21.98
DRAFT	M	3.95	Ft	12.95
DISPLACEMENT	Kg	59,200	Lbs	130,513
BALLAST	Kg	22,900	Lbs	50,485
NAVAL ARCHITECT	Farr Yacht Design			
INTERIOR DESIGNER	Nauta Design			
HULL COLOUR	Anthracite			
CLASSIFICATION	RINA Class Certificate C HULL• MAC, Ych, (In Class)			
CONSTRUCTION MATERIAL	Infused Composite Sandwich, engineered by SP Systems			
ENGINE	Cummins QSB 5.9 MCD 305Hp [7.450 hours in April 2019]			
TANKS	FUEL 3,800L (1,004USg) WATER 2,000L (528.3USg)			
ELECTRICAL SYSTEM	DC 24V AC 240V			
MAST & BOOM	Nordic Mast hi-modulus mast and park avenue boom, ECsix rigging			
DELIVERED	July 2008			
FLAG – PORT OF REGISTRY	Malta -Valletta			
LYING IN	Monfalcone, Italy			
ASKING PRICE	4,900,000 Under Leasing			

COMMENTS

Between 2006-2007, the Southern Wind 100 quickly became the most sought after 100-foot sailing yacht and remarkably, six yachts were delivered in this short time. Having already been proven as a fast and versatile performance cruiser, Southern Wind and their partners at Farr and Nauta Design sought to further develop the regatta potential of the SW100 and Mrs. Seven is the result. With an increased righting moment compared to the 100DS models, Mrs. Seven is the first Raised Saloon (RS) version and this reengineered and redesigned evolution of the SW100 has introduced a sleeker, more modern deck profile while increasing the feeling of volume and space in the saloon.

On deck, she features the classic two cockpit arrangement where the central area is out of the action and a comfortable place for guests to relax and take meals around the dining table. The aft cockpit contains the helm positions and sailing controls while also providing access to the crew area.

Down below, Mrs. Seven features a spacious four-cabin arrangement, accommodating up to eight guests. Master cabin is forward with VIP cabin and the studio lounge located forward of the saloon. The main saloon features a comfortable seating area to starboard and eight-seat dining table to port.

Moving aft down the short staircase, two additional Ensuite guest cabins are located. The crew occupy the after quarters comprised of two crew cabins, nav station, galley and crew mess.

In winter 2015-2016 Mrs. Seven underwent refit works including the stern modification, widening approx. 50 cm, managed by TriMarine composite specialist on the concept realized by FARR Yacht design, Felci Yacht design and Southern Wind Shipyard.

The refit included the following works:

- Transom modification with new modern design
- Complete fairing and painting of the hull, deck and superstructure in Awlcraft Matterhorn white
- Full mast & rigging service with NDT of mast tube, boom and spreaders
- Repainting of mast, boom and spreaders in white Awlgrip
- Standing rigging replaced with new ECsix (side rigging, head stay, inner forestay, backstay)
- Bamar jib furler complete overhaul (staysail furler serviced in 2014)
- New deck upholstery and new bimini and covers
- Major overhaul of engine and generators
- AirCon system, new motors in fan coils, all new pumps
- Fire pumps replacement
- Anchor arm motor overhaul (APM)
- Electronic systems upgrade including new displays and communications
- All floorboards refinished
- Upgrading and painting in showers and heads
- New cockpit cushions and covers
- All deck lockers (Forepeak, lazarette, anchor locker) repainted
- New upholstery in saloon
- All new deck canvas

Mrs. Seven is currently lying in Monfalcone, Italy and undergoing an extensive winter maintenance program. In early April, she will be ready for inspection and available to visit by appointment

HULL & APPENDAGES

Construction

The hull is built on a female mould, using infusion technology, with SP SYSTEM epoxy resin. Outer skin is glass & Kevlar, inner skin is carbon and core is Corecell, vacuum bagged to obtain maximum bonding. The hull is reinforced with pre-fabricated structural floors, stringers and longitudinals

Bulkheads are glass or carbon fibre sandwich construction
Hull windows – four on each side, in saloon and guest cabins

Hull Finish

Hull is painted in Dupont anthracite metallic grey with Awlcraft clear coat, 2016
Black boot stripe in vinyl

Max Power R321/4 32.5 hp bow thruster, hydraulically driven by PTO

Keel

The fixed T-bulb keel is comprised of steel fin and antimony hardened lead torpedo bulb
Steel fin keel (2,300kg) and torpedo bulb (20,150 kg)

Rudder

The spade rudder is constructed from pre-preg carbon fibre with closed cell polyurethane foam core.
Pre-preg carbon fibre rudder stock and blade is carbon fibre on foam core
Mounted on two self-aligning bearings from Solimar

Steering Systems

Twin composite steering pedestals fitted in cockpit with roller bearings and flush mounted consoles,
accommodating steering compasses and other instruments
Twin Solimar carbon fibre wheels, 1200mm diameter
Chain and sprocket steering system connected to lightweight alloy quadrant (new sprockets 2019)
Simrad Autopilot with single piston

Transom

Hydraulic folding swim platform, 2x pistons
Hot/cold shower and storage lockers

DECK

Deck Construction

The deck is built on a female mould, using infusion technology, with SP SYSTEM epoxy resin.
Both inner and outer skins are carbon fibre and core is Klegcell, vacuum bagged to obtain maximum bonding.
Pilot house superstructure is also built in carbon fibre laminate

Deck Finish

Deck is painted in Matterhorn white Awlcraft (new 2016)
Teak deck laid on foredeck, side decks, aft deck, cockpit floors and seating.
Recalced in 2019

Deck Lockers

Anchor locker with access to chain storage
Forepeak locker with storage for sails, rigging and equipment
Lazarette locker aft
Life raft lockers on either side of cockpit

Deck Arrangement

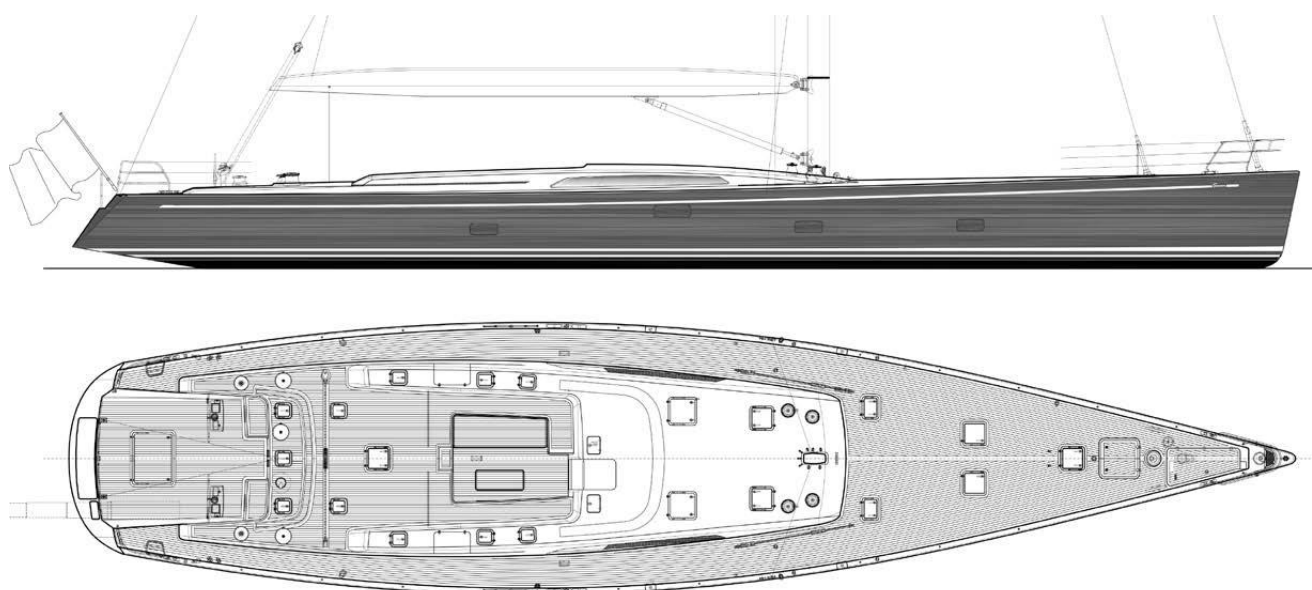

Deck Equipment

Centre cockpit table, finished in teak with folding leaves and integrated icebox
 Stainless steel pulpit, pushpit, stanchions and side opening gates
 Carbon swimming ladder with fixing points on swim platform

Hatches & Windows

Flush mounted composite deck hatches from SWS, supported by double gas rams
 New Perspex on foredeck hatches 2019
 Oceanair mosquito screens and blinds on all hatches
 Sliding polycarbonate companionway hatches and washboards. Main companionway washboard electric dropdown

Winches by Harken

Primaries: 2 x 1130 STA 3-speed hydraulic
 Secondaries: 2 x 1111 STA 3-speed hydraulic
 Mainsheet 1x 1111 STA 3-speed hydraulic
 Traveler 1x 65 STA 2-speed hydraulic
 Halyard 2 x 990 STA 3-speed hydraulic
 Pit: 2x 990 STA 2-speed manual
 Sanguinetti retractable mooring winch on foredeck, complete over haul 2018

Sailing Hardware

Frederiksen / Ronstan deck hardware
 Spinlock jammers and clutches
 Antal puffer switches

Anchoring & Mooring

Main anchor CQR 180lb with 140m of 14mm chain, chain replaced in 2016
 Spare anchor 37Kg Fortress FX 125 with 20m of chain and 100m rhode, mounted in forepeak
 Hydraulic retractable aluminium anchor arm, folds away flush inside the anchor locker
 Maxwell 4500 model hydraulic anchor windlass
 Eight (8) fixed custom retractable cleats (2x bow, 4x stern)
 Two retractable cleats on stern
 Fenders and mooring lines

Deck Canvas

2x Folding sprayhoods
 Sun awning connecting to boom
 Bimini over centre cockpit with side curtains
 Mainsail cover
 Winch covers
 Steering pedestal and wheel covers
 Cockpit table covers

Cockpit cushions with back rests

INTERIOR

General

Interior furniture is made to the highest marine standards, using teak and, where possible, sandwich construction with closed-cell PVC or resin-sealed paper honeycomb core, to reduce the weight.
 Inside of lockers is finished in cedar veneer
 Removable sandwich construction floorboards are finished in satin varnished teak
 Removable overhead panels are covered in Ledertex Nerini material.
 Flush mounted overhead halogen lighting throughout
 Saloon upholstery
 Corian countertops in crew heads & galley, marble in guest heads
 Honeycomb floorboards with teak veneer

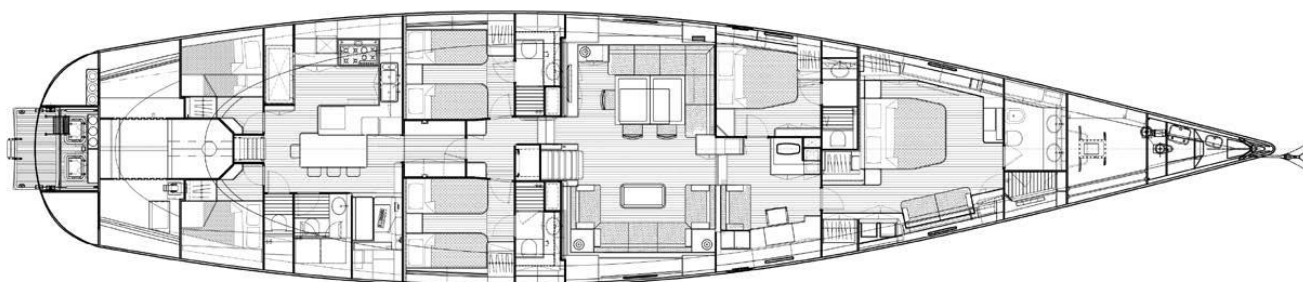

Forward Cabin (Master)

Double berth with night stands and reading lights on either side aft and storage drawers beneath
 Dressing area aft to starboard with cedar lined drawers and lockers
 Two-person settee to starboard with book shelves above and hull window outboard
 To port, a hanging locker aft with shoe storage, book shelves and hull window.
 Vanity desk with removable seat and retractable television forward to port
 En suite head with Tecma WC & bidet, separate shower compartment, double wash basins, mirrors and storage lockers

Forward Guest Cabin

Double berth to port with bookshelves, lockers and hull window outboard
 Hanging locker and storage lockers forward to port
 En suite head with Tecma WC, separate shower compartment, wash basin, mirrors and storage lockers

Studio Lounge

In the forward starboard section of the saloon, adjacent to the forward guest cabin, a convenient studio and lounge area is located with writing desk, 2-seat settee and bar with drinks refrigerator

Saloon

Eight-person teak finished dining table to port with television and storage lockers for tableware aft
 To port, a comfortable seating area with large settee, two seats and a coffee table
 Hull windows on either side outboard

Aft Cabin (Port)

Twin single berths on either side with storage lockers and bookshelves above
 Night stand with drawers between the berths, hanging locker forward and outboard
 En suite head with Tecma WC, separate shower compartment, wash basin, mirrors and storage lockers

Aft Cabin (Starboard)

Twin single berths on either side with storage lockers and bookshelves above
 Night stand with drawers between the berths, hanging locker forward and outboard
 En suite head with Tecma WC, separate shower compartment, wash basin, mirrors and storage lockers

Galley

Open plan galley design with central island that doubles as work surface or dining table with removable seats
 Work surfaces finished in Corian
 Double stainless-steel sinks, storage lockers and drawers for galley equipment

Galley Equipment

Front loading column refrigerator, 570 litres
 Front loading freezer, 305 litres
 One top-loading freezer below cabin sole in galley, 105 litres
 U-line ice maker, replaced 2018
 Alpes Inox 5 gas burners +1 electric hob cooker combination with Smeg 70 cm wide oven both mounted on a custom-made gimballing system.
 Combi microwave oven
 Alpes inox extractor galley extractor / hood above the cooker
 Mixer faucet for hot and cold water with extractable shower head.
 Miele washing machine (2015)
 Miele dryer (2016)
 Comenda dishwasher (2018)
 Trash compactor

Nav Station

Forward facing navigation desk with opening top nav table
 Flush mounted instruments and displays
 Storage lockers drawer and shelf for nav aids

Engine Room

Insulated with sound and vibration dampening materials
 Fire protection to A60 rating
 Extraction and ventilation fans, G&R 24v rebuilt by manufacturer 2018
 2x video cameras connected to computer and nav screens

ENGINE & SYSTEMS

Main engine is a Cummins QSB 5.9 MCD 305 hp@2.600 rpm (6,714 hours in April 2018)
 ZF 301A reduction and reversing gear with 70mm shaft and four-blade folding Brunton Varifold propeller
 All new injectors (2019) 2x new fuel pumps
 After cooler core new 2019, new turbo 2019

Max Power R321/4 32.5 hp bow thruster, hydraulically driven by PTO (rebuilt 2017)

Fuel System

Two integrated composite fuel tanks with total capacity of 3,800 litres
 San Giorgio Sein level monitoring system
 One stainless steel day tank with 170 litres capacity
 G&R 24v transfer pump with filter

Plumbing Systems

Pressurized hot/cold freshwater system

Two integrated composite water tanks with 2000 litres capacity

Two G&R Eco jet 24v DC freshwater pump (rebuilt annually)

Two 80-liter hot water heaters

2x 24v DC Spectra water makers (#1: 10.100,2 hrs - #2: 9.985,4hrs – April 2019) 150 liters per hour (Clark pump up-grades 2019 & electric motors and low-pressure pumps replaced 2018)

One G&R seawater pump for deck wash and firefighting (rebuilt 2018)

Cathelco active cathodic protection for main sea water manifold

Ventilation System

Frigomar Air Conditioning with 96,000 total BTU

Fan coils and controls in all cabins, saloon and galley

Refrigeration Systems

3x Frigomar refrigeration compressors, can be operated on 24vDC or 220vAC

Drainage System

All marine WC by Tecma, can be operated on fresh or seawater system

Two composite blackwater tanks, total capacity 720 litres

G&R macerator pumps connected to each black water tank

50mm deck waste pump out fittings, one for each tank

Six individual bilge areas may be pumped out via manifold

2x G&R 24v pumps and one Whale Gusher manual pump connected to manifold

Two Johnson pumps permanently connected to main bilge and engine room bilge

Hydraulic Systems

Powered hydraulic system is supplied by Max Power power-pack with two 13 kW DC electrical motors or Power Take Off pump on generator. 2x new motors in 2015

Powered hydraulic functions:

- Winches (8)
- Furlers (2)
- Windlass (1)
- Mooring winch (1)
- Transom door (1)
- Anchor Arm (1)

Bamar hydraulic system: powered by manual pump or dedicated power pack

Hydraulic functions: Backstay, Vang, Outhaul, Inner forestay, jib halyard tensioner, Staysail halyard tensioner.

ELECTRICAL SYSTEM**General**

Electric system is installed in conduits, alongside the hull, with junction boxes provided and secondary distribution panels.

Wiring numbered on both ends and laid down to be accessible for checking and servicing.

DC System

Service Batteries: two (2) battery packs, each made of Sonnenschein Dry Fit units 24 volt - 1000 Ah each, for a total of 2000 Amp 560 Ah 24V

Navigation Batteries: One (1) battery pack, with two (2) batteries Sonnenschein Dry Fit, 160Ah 12V connected in series. To be changed in 2019

Engine & Genset start: one (1) battery pack, with two (2) batteries Sonnenschein Dry Fit, 160 Ah 12 volts connected in series. New 2016

AC System

Shore power system – 2x watertight sockets on lazarette with 2x 25m shore power cables (one dedicated to air conditioning)

Main generator - Onan 22,5 kw 50 Hz, mounted into a sound insulation box. (16.110,4 hrs – April 2019)

Secondary generator - Onan 11.5 kW 50Hz, mounted into a sound insulation box (13.823,2 hrs – April 2019)

Chargers/Inverters

Victron 100-amp battery charger for service batteries

Victron 50-amp charger for navigation batteries

Two (2) Victron Combi chargers/inverters 70-amp 24v/2500W

Engine and genset batteries charged via dedicated alternators on each engine

ELECTRONIC SYSTEMS

Navigation Instruments

B&G H3000 with performance processor, gyrocompass, mast head unit (wind speed/direction, speed sensor and 2x depth sensors (one forward, one aft)

2x 30/30 on deck

2x 20/20 on deck

2x FFD on deck

1x FFD in captain cab

1x FFD at Nav station

4x Garmin maxi displays at gooseneck

Furuno chart plotter black box system integrates with MaxSea, displays at nav station and helm

Radar: Furuno 36 nm ARPA module, radome on front of mast

GPS: Navstar MX500 @ Navstation

Autopilot: SIMRAD AC20; 2 displays AP26. – one cylinder

Garmin maxi displays near gooseneck

Computer Systems

Two Hi-performance Computers (Navigation + Communication)

Epson printer/scanner

Wireless keyboard and mouse

Max Sea Time Zero software

Communications Systems

AIS Rx and TX SIMRAD A150

Icom M801E GMDSS SSB

Icom IC 603 VHF with handsets at helm and nav station

Fleet 250 BB Sat Com

MINI C T&T TT3026D

Ericson W25 4band GSM

Pepwave hi-powered WIFI router

Navtex

2 Video Cameras in engine room and 2 x first spreaders

Maretron atmospheric and weather monitor

Entertainment Systems

Sky Decoders (2016) in Master, saloon and crew cabin

Saloon - Audio Denon AVR 2308 home theatre Video DVD Denon 1930

Sony 50" LCE television

Owner: Audio Video S 302 + I-Pod dock Denon stereo, Sony 36" TV SONY 26 KDL P3000

Guest cabins: 3 x Denon S302 hi-fi

Galley: TV & Stereo to be installed 2019

Deck: Cockpit speakers in both cockpits, FWD connected to saloon Denon, aft connected to crew stereo

MAST & RIGGING

Mast: Nordic Mast - Carbon Fiber High Modulus – 3-spreader

Boom: Nordic Mast – Park avenue - Carbon Fiber

ECsix standing rigging (side rigging, headstay, inner forestay, backstay)

Genoa furler, Bamar hydraulic with carbon foil

Stay furler Bamar flush with carbon foil

Removable mast jack with manual pump

Upward lights on each spreader, downward lights on lower spreader

Bamar hydraulic cylinders with electric and manual pump controlling backstay, vang, outhaul, inner forestay adjuster and genoa halyard

Extensive running rigging inventory available on request

During winter 2017-2018, a study was carried out to improve the upwind performance and balance of the yacht by adjusting the sail plan and mast geometry. The mast foot was moved forward by 30cm allowing a greater angle of rake. The result is a more balanced helm with light weather helm when sailing upwind. Furthermore, there has been a noticeable improvement in boat speed.

Dimensions:

L: 36.300 m.

P: 35.470 m.

J: 10.700 m.

E: 12.230 m.

Sail area (with 106% genoa) 463 sqm

Mast Antennas

VHF, SSB & DSC masthead

Navtex

Seatel C24 Sat TV – Stbd first spreader

Fleet 250 BB Sat Com – Port first spreader

Maretron atmospheric

AIS

SSB antenna in backstay

EQUIPMENT

General Equipment

Dariel DT5 Custom 5.2m Rigid inflatable tender + Evinrude E-Tec 90hp 2-stroke

New Hypalon tubes in 2017, repainted inside in 2018

Stainless chocks for foredeck

Manually retracting custom carbon Passarelle (retractable into a dedicated storage locker)

Safety Equipment

4x life raft 6-person arimar, all on hydrostatic float away

1x Jonbuoy

SART
 2x EPIRB (McMurdo & ACR)
 FM200 firefighting in engine room
 Portable fire extinguishers throughout, new 2018
 MOB (man over board) locator system: Wave Finder
 Lifejackets
 Extensive medical supplies

SAILS

Sail	Year	Sailmaker	Material/Notes
MAINSAILS			
Cruising main	2016	Millennium	Laminated sail with taffeta finish, full batten, 3 reefs
UPWIND			
Furling jib	2017	Millennium	Laminated with taffeta finish
Staysail	2018	Millennium	Laminated with taffeta finish
DOWNWIND			
VMG Gennaker	2008	Quantum	Red with white 'Seven' logo, bucket snuffer from 2018
Reaching gennaker	2009	Quantum	Red with white writing, bucket and snuffer

Price may be changed without notice
Boat is offered subject to still being available
The particulars are believed to be correct but not guaranteed

